

## Research Encounters

Any **one** of four items listed on an encounter will flag UPI of charges may be associated with a research grant: **1) Clinic appointment scheduled with protocol (grant #) attached; 2) Charge Dx V70.7; 3) Charge Modifier ZR; 4) Guarantor = "Research."** Any **one** of these parameters will flip the FSC to Grant/Research (700) in CB. All grant/research charges are manually reviewed by UPI.

1. Click **Epic** → Patient Care → Research Studies
2. Pull up patient (e.g. name, mrn, etc)
3. The Research Studies screen automatically shows all *Enrolled* studies.
  - a. Click the *Inactive*, *Pre-enrollment*, and *Deleted* options to search for other studies (see screen shot below). This document will focus only on *Enrolled* studies.

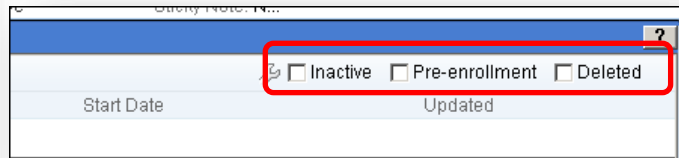
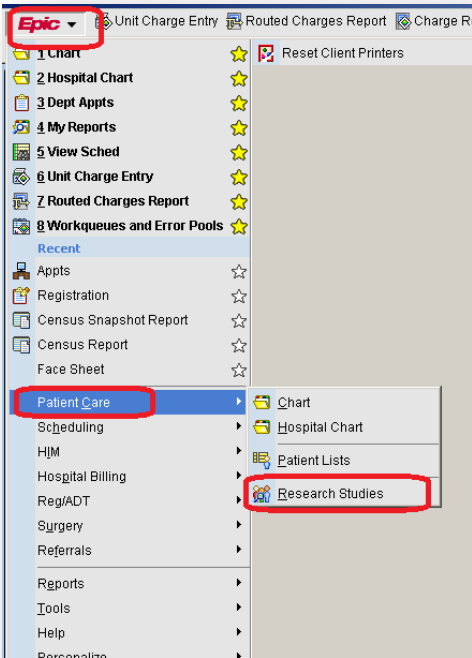

**NOTE:** Enrolled will always be displayed. Selecting one of the options above will only add new entries in the Research Studies screen below the *Enrolled* section.

The screenshot below demonstrates a "deleted" study. Note the second entry has text displayed as ~~strikethrough~~ indicating it is a deleted study

Research Studies				
Research Studies List is currently read-only.				
	Study Code	Coordinators	Start Date	<input checked="" type="checkbox"/> Inactive <input checked="" type="checkbox"/> Pre-enrollment <input checked="" type="checkbox"/> Deleted Updated
<b>Enrolled</b>				
GF14 CTO PH1 REGN421	GF14		9/5/2013	MARTIN, TAYLER on 9/5/2...
<a href="#">Enrollment Comments</a> Sharon H X80667				
M050-MANAGED-MEDICARE-GRANT	M050		9/5/2013	MARTIN, TAYLER on 9/5/2...
<a href="#">Study Details</a> Description: Managed Medicare Grant				

Click to jump to:



[UCH Research Studies Activity](#)



[CHCO Research Studies Activity](#)

**NOTE: UCH and CHCO Research Studies' displays are configured slightly different. Go to page 3 for CHCO details.**

**UCH Research Studies Activity**

4. If patient is enrolled in any research study, "Research: Active" will be highlighted in pink in the patient banner. If patient is not enrolled in any research study, this field will not display

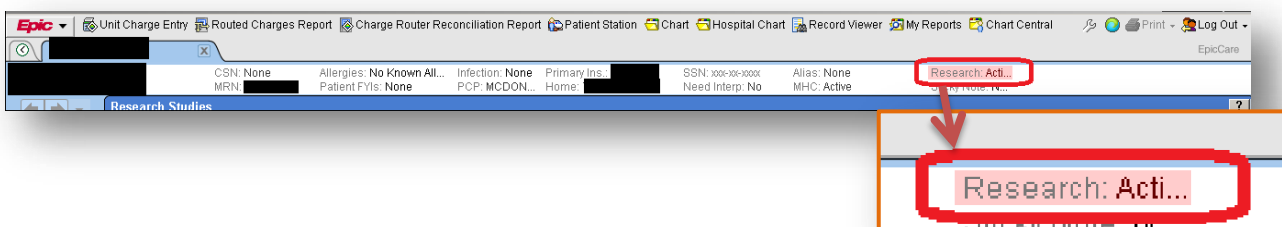

5. When the Research Studies window displays, the following information will be available:
  - a. Coordinator's Name
  - b. Principal Investigator's Name
  - c. Study Code ("Grant Number" in CB)

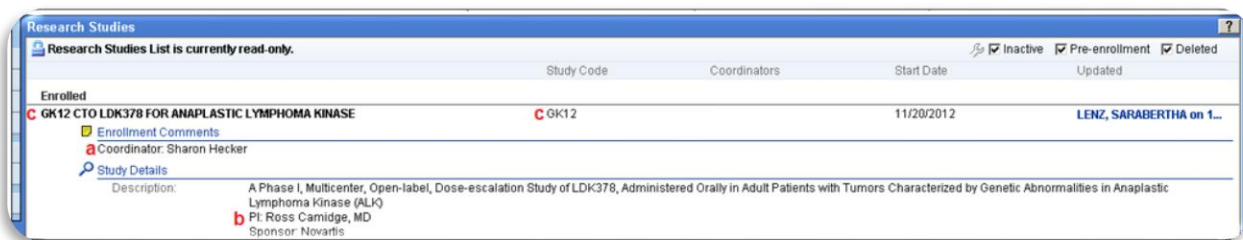

6. The "Study Description" describes what the study is about, and may not provide insight to what procedures are covered under the grant – contact the coordinator with questions
7. Questions about the study/grant should be directed to the Coordinator
8. Questions about accessing the Research Studies Activity in UCH EPIC or UCH EPIC system problems can be directed to the UCH HelpDesk at X84000 or 720.848.4000

**NOTE: CHCO and UCH Research Studies' displays are configured slightly different. Go to page 2 for UCH details.**

**CHCO Research Studies Activity**

4. If patient is enrolled in any research study, "Research: Active" will be displayed in the patient banner. If patient is not enrolled in any research study, this field will not display

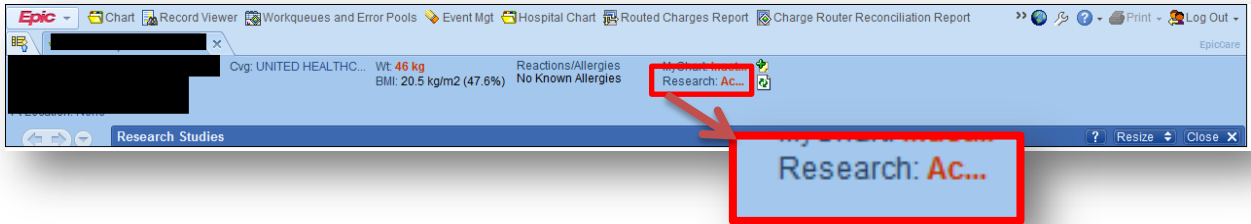

5. When the Research Studies window displays, the following information will be available:
  - a. Coordinator's Name
  - b. Coordinator's Phone Number
  - c. Principal Investigator's Name
 

**Note:** Some PI's do not have privileges at CHCO, in which case the PI field would be blank
  - d. Study Code ("Grant Number" in CB)
  - e. All encounters associated with the study



6. The "Study Description" describes what the study is about – contact the Grant Administrator with questions
7. Click the "Report" link to display the information differently, along with additional details

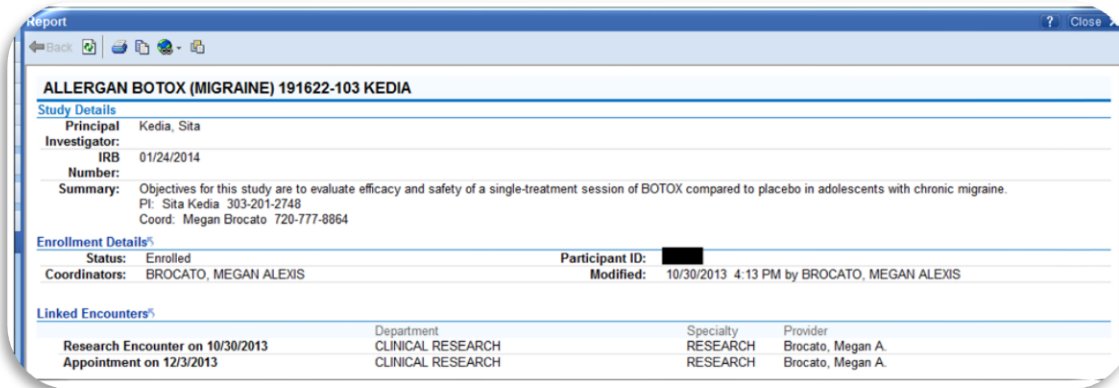

8. Additional encounter information can be found in the chart review tab in the patient's chart
9. Questions about the study/grant should be directed to the Grant Administrator which can be found on the monthly active studies report

10. Questions about accessing the Research Studies Activity in CHCO EPIC or CHCO EPIC system problems can be directed to [casresearchteam@childrenscolorado.org](mailto:casresearchteam@childrenscolorado.org)